

PROFILE MPOFS-654GPSB



*Flush-Mount Installation Kit is included with each sink
*Custom ADA compliant versions are available

FEATURES

- 16-gauge type 304 stainless steel
- Solid brass under rim support
- 1/4" round profile basin

TECHNICAL INFORMATION

- External dimension: 24" L x 17.5" W x 10" D
- Basin dimensions: 23" L x 16.5" W x 10" D
- Frame width: 1/2" • Frame thickness: 5/16"

FINISHES

- Graphite PVD Satin Brushed stainless steel

INSTALLATION OPTIONS

- Flush-mount • Drop-in

MINIMUM CABINET SIZE (I.D.)

- Flush-mount 25"

INDUSTRY'S ONLY STAINLESS STEEL SINK DESIGNED SPECIFICALLY TO BE FLUSH-MOUNTED

INTERNATIONAL PATENT PENDING

INSTALLATION TYPE

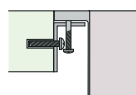

Flush-mount



Included MTK-617SS
Flush Mount Kit

OPTIONAL ACCESSORIES

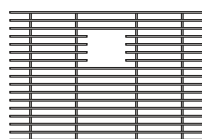

MBG-654GPSB
Basin Grid

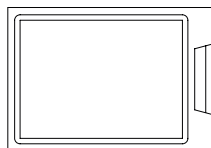

MCB-651BB
Cutting Board

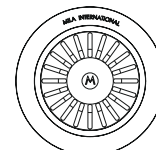

MKD-101GPSB
Strainer

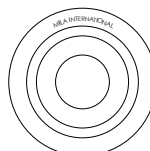

MDC-101GPSB
Disposal Collar

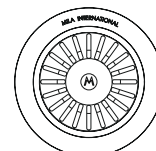

MDC-102GPSB
Disposal Collar

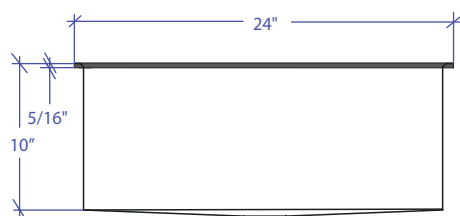
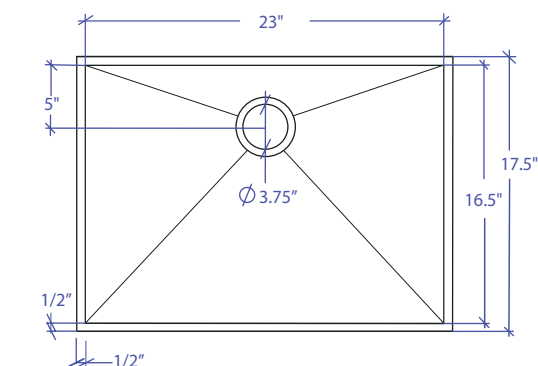

PROJECT INFORMATION			
Project			
Date	/ /	QTY	
Specifier			
Contact			
Note			